

Attachment A8

**Revised Reference Design, dated 15
September 2021**

Green Square Sydney Site 8A & 8B Reference Design

Sheet Number	Sheet Name
RD-00-01	Site Plan
RD-01-01	Basement 3
RD-01-02	Basement 2
RD-01-03	Basement 1
RD-01-04	Ground Level
RD-01-05	Level 1
RD-01-06	Levels 2 - 8 (Typical Podium Levels)
RD-01-07	Level 9
RD-01-08	Levels 10 - 16 (Typical High Rise Levels)
RD-01-09	Level 17 (Plant Level)
RD-01-10	Levels 18 - 22 (Typical High Rise Levels)
RD-01-11	Level 23 (Roof Plant)
RD-02-01	Section 1 (North South)
RD-02-02	Section 2,3,4 (East West)

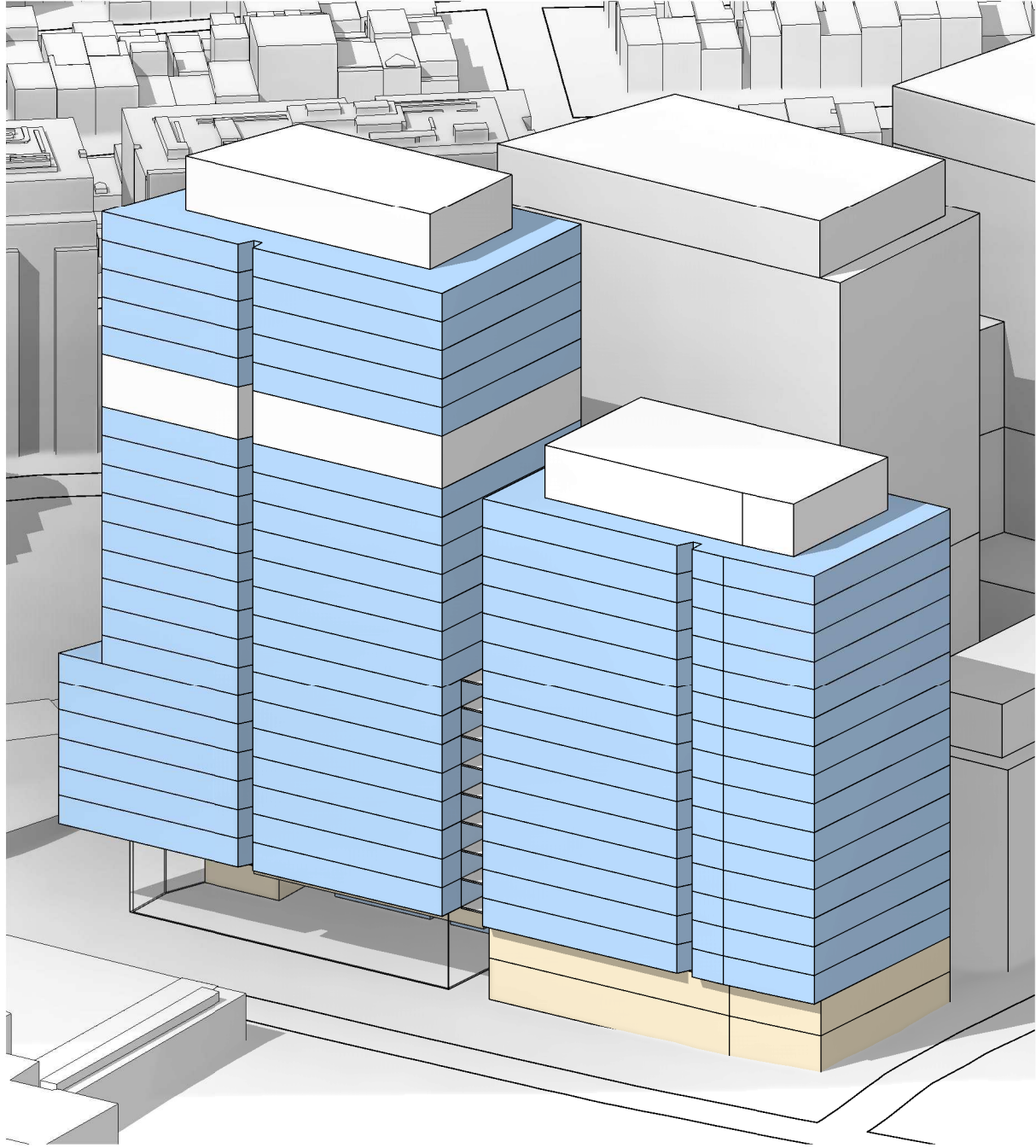

208



Green Square Site 8A & 8B

Drawing:
 Drawing no:
 Issue:
 Scale @ A3:
 Date:

Site Plan
 RD-00-01
 1 : 1000
 15/09/21

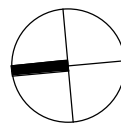

Architectus Sydney
 Level 18 MLC Centre
 19 Martin Place
 Sydney NSW 2000
 sydney@architectus.com.au

303

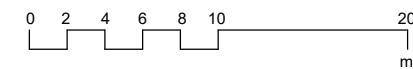
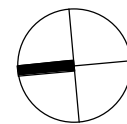
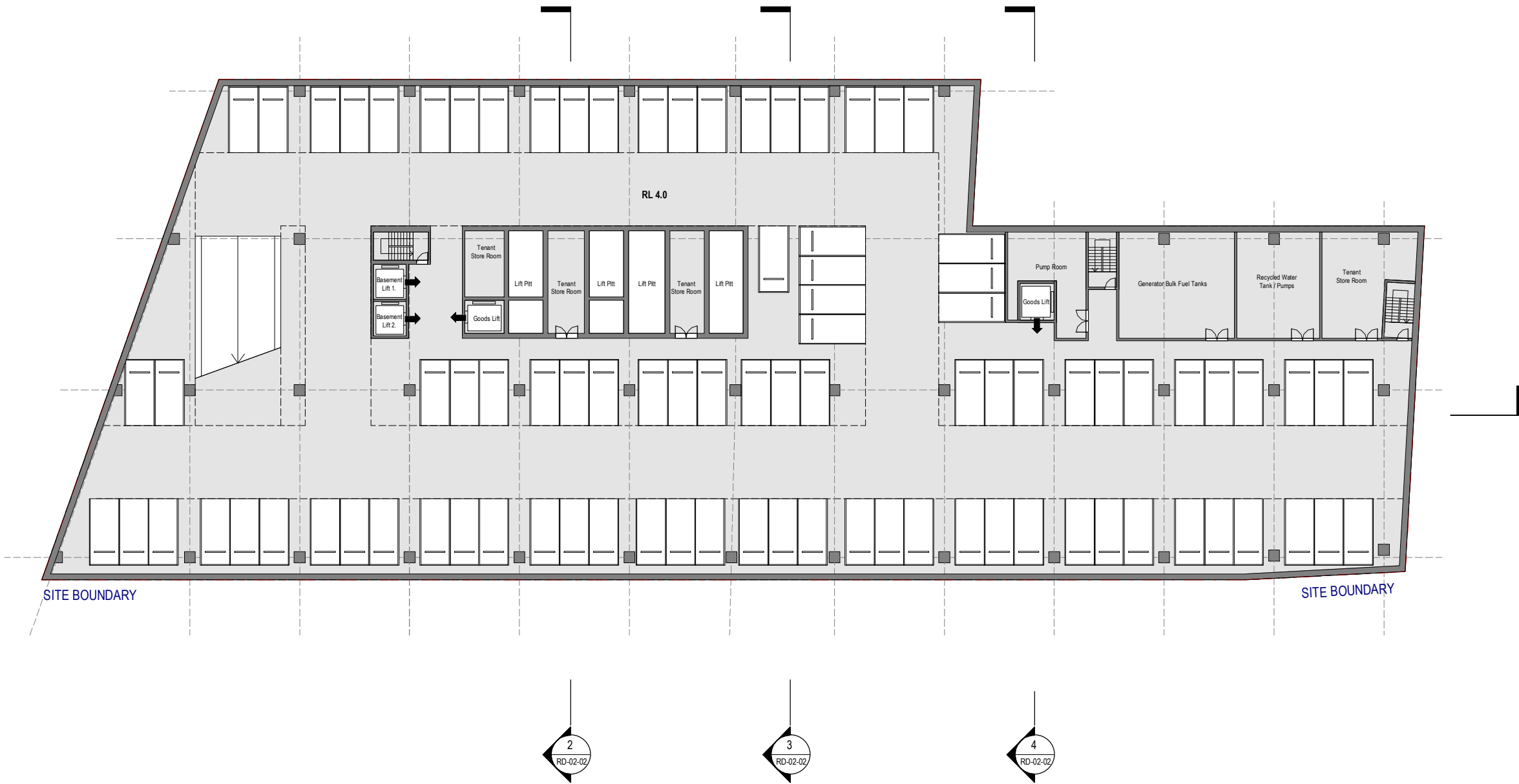

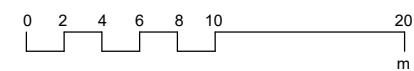
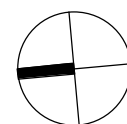
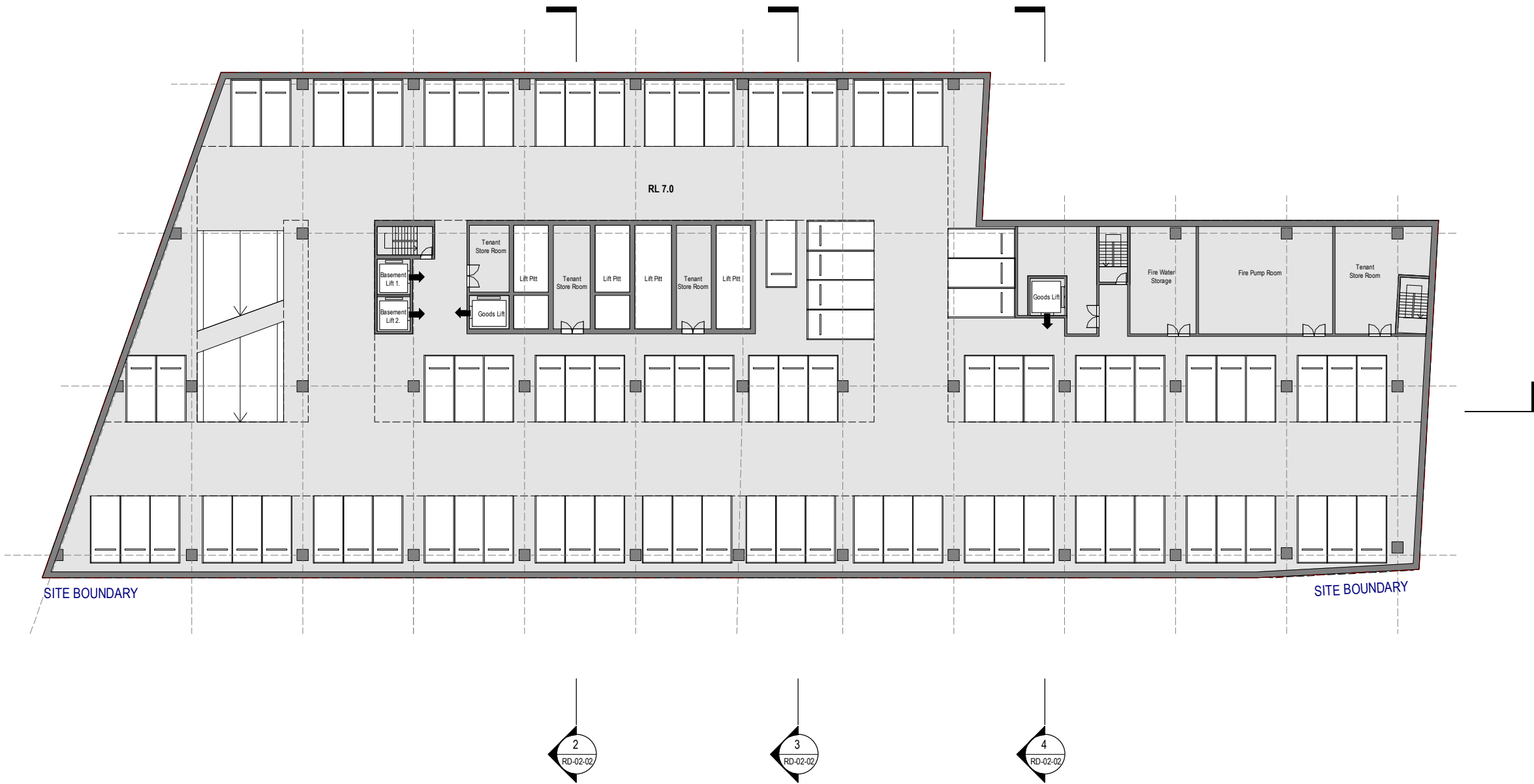

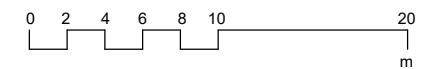
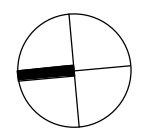
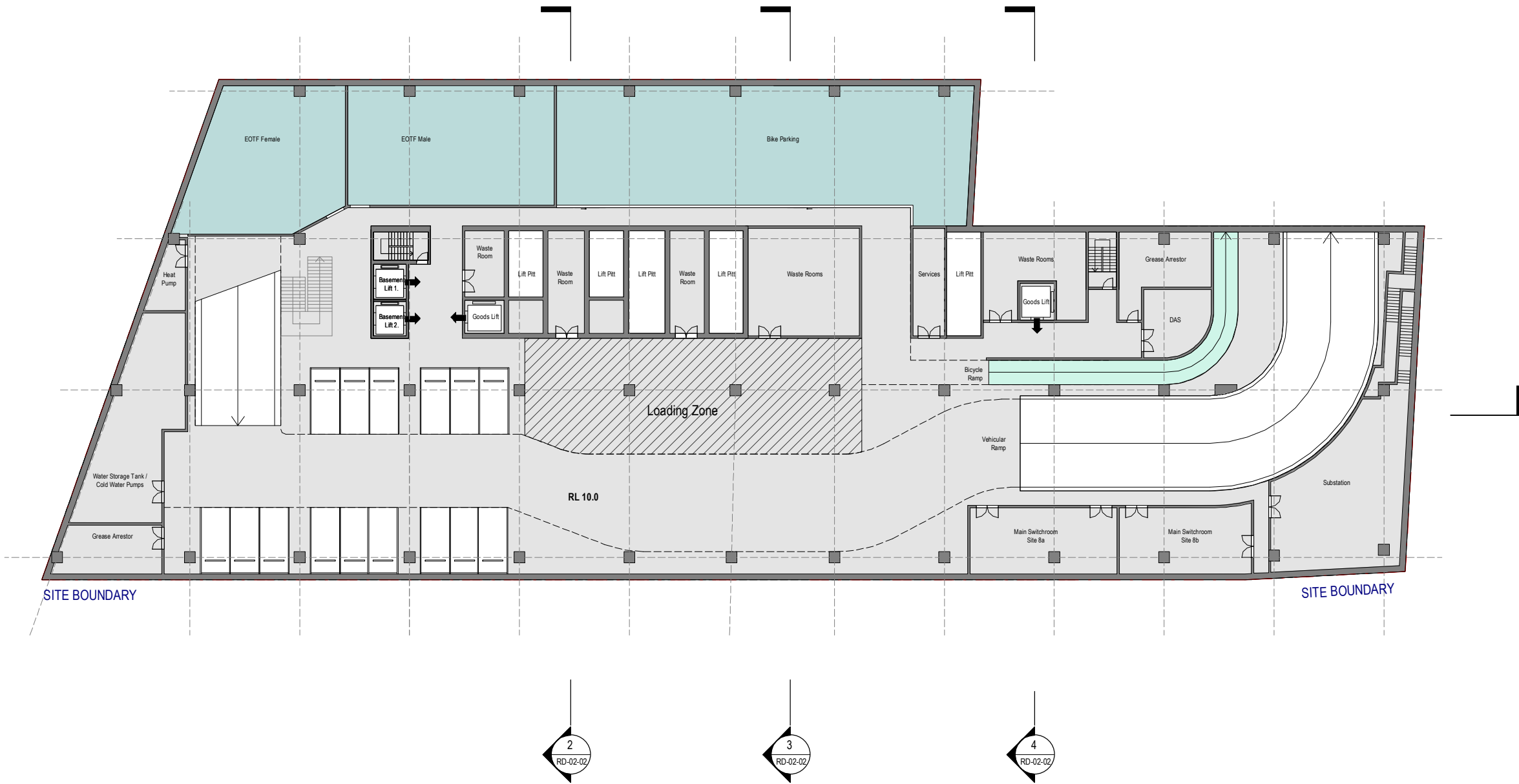

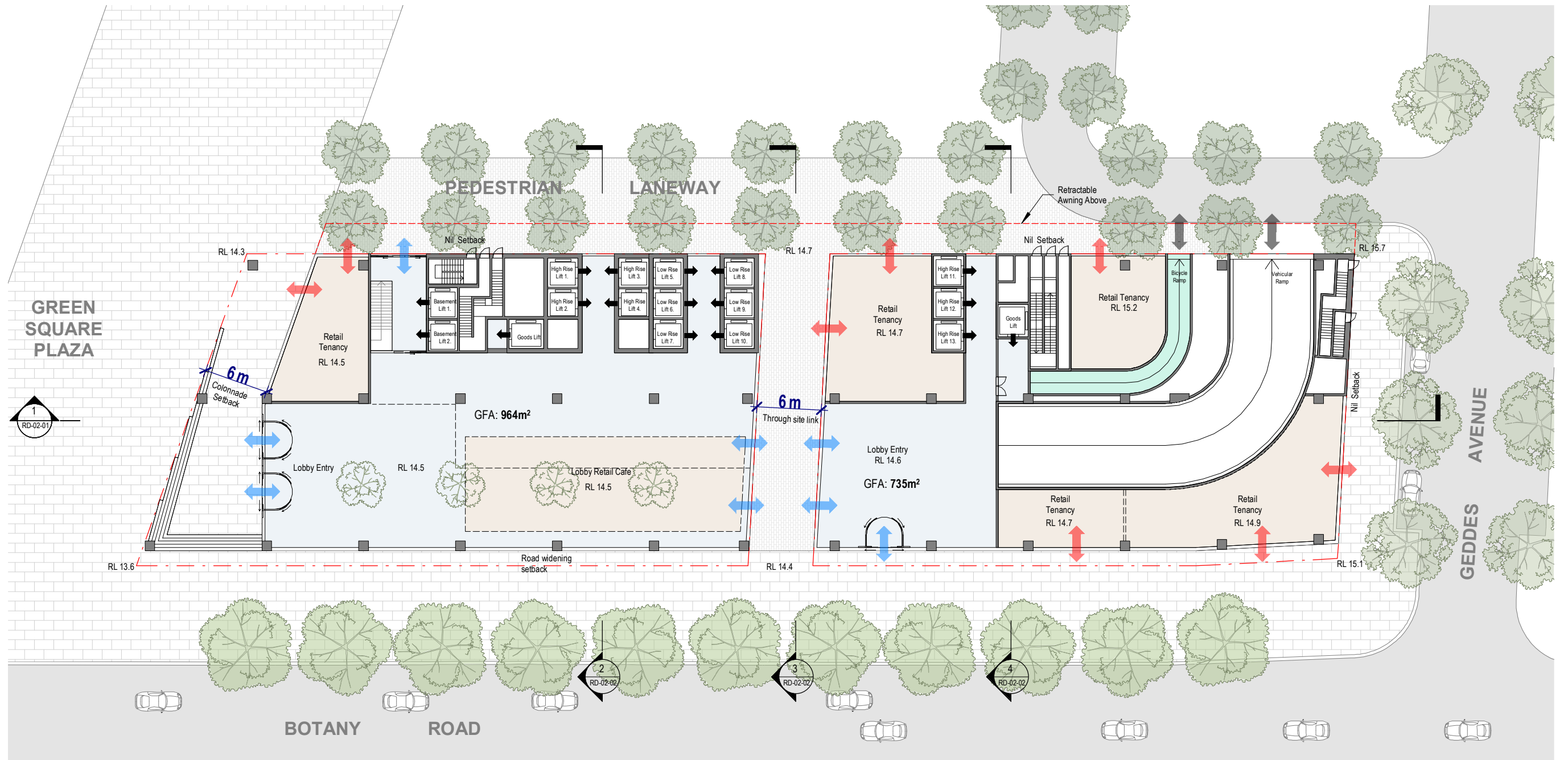

Green Square Site 8A & 8B

Drawing: **Ground Level**
 Drawing no: RD-01-04
 Issue:
 Scale @ A3: 1 : 400
 Date: 15/09/21

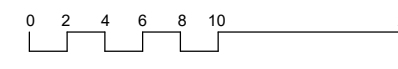
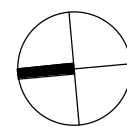

Architectus Sydney
 Level 18 MLC Centre
 19 Martin Place
 Sydney NSW 2000
 sydney@architectus.com.au

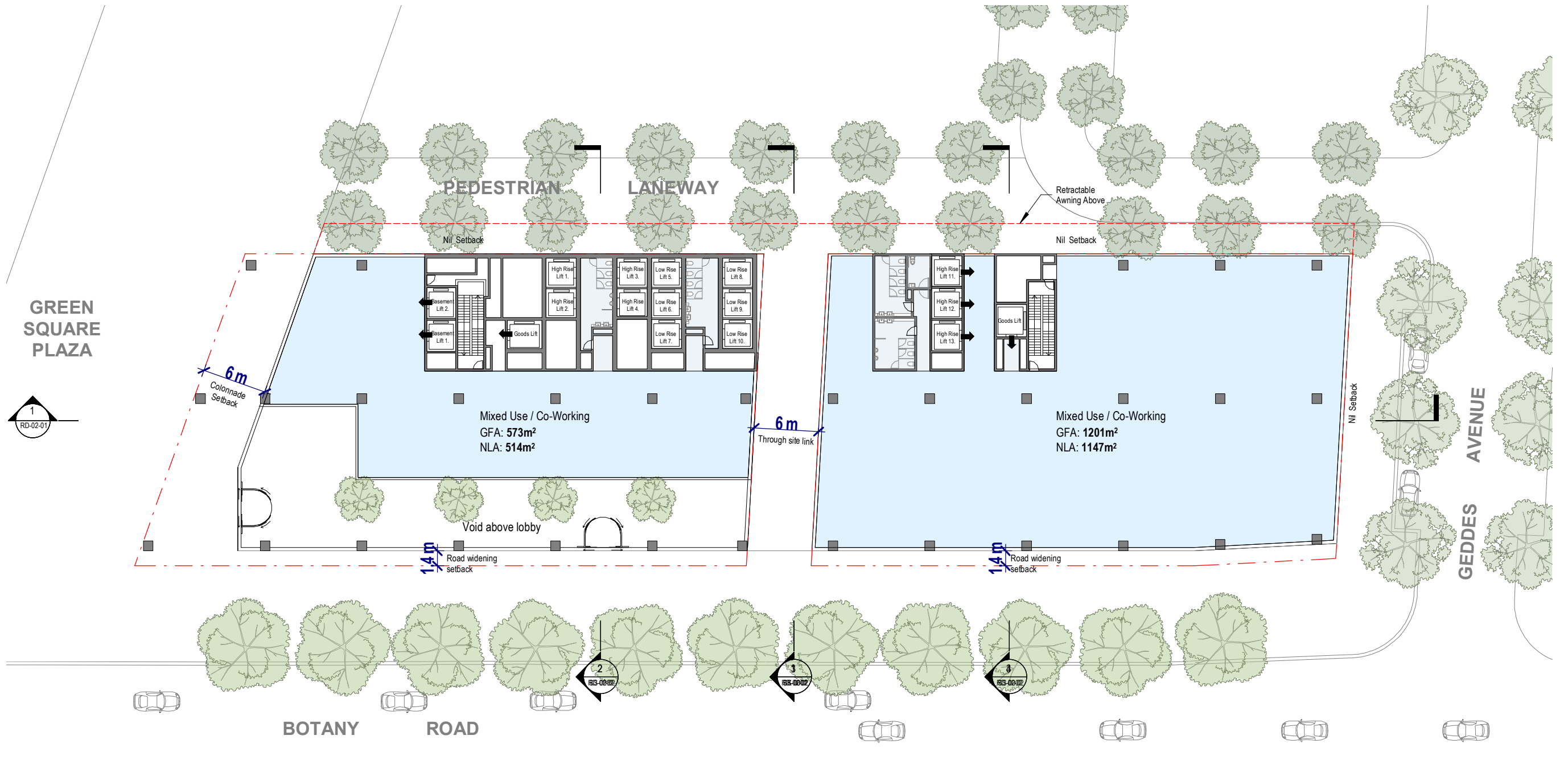

Green Square Site 8A & 8B

Drawing: **Level 1**
 Drawing no: RD-01-05
 Issue:
 Scale @ A3: 1 : 400
 Date: 15/09/21

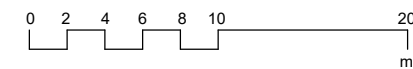
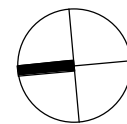

Architectus Sydney
 Level 18 MLC Centre
 19 Martin Place
 Sydney NSW 2000
 sydney@architectus.com.au

308



Green Square Site 8A & 8B

Drawing: **Levels 2 - 8 (Typical Podium Levels)**
 Drawing no: RD-01-06
 Issue:
 Scale @ A3: 1 : 400
 Date: 15/09/21

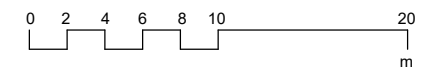
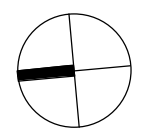

Architectus Sydney
 Level 18 MLC Centre
 19 Martin Place
 Sydney NSW 2000
 sydney@architectus.com.au



300

GREEN SQUARE PLAZA

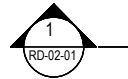

BOTANY ROAD

GEDDES AVENUE

Green Square Site 8A & 8B

Drawing: **Level 9**
 Drawing no: RD-01-07
 Issue:
 Scale @ A3: 1 : 400
 Date: 15/09/21

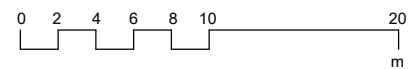
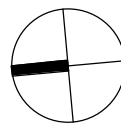

Architectus Sydney
 Level 18 MLC Centre
 19 Martin Place
 Sydney NSW 2000
 sydney@architectus.com.au

architectus™

300



GREEN SQUARE PLAZA

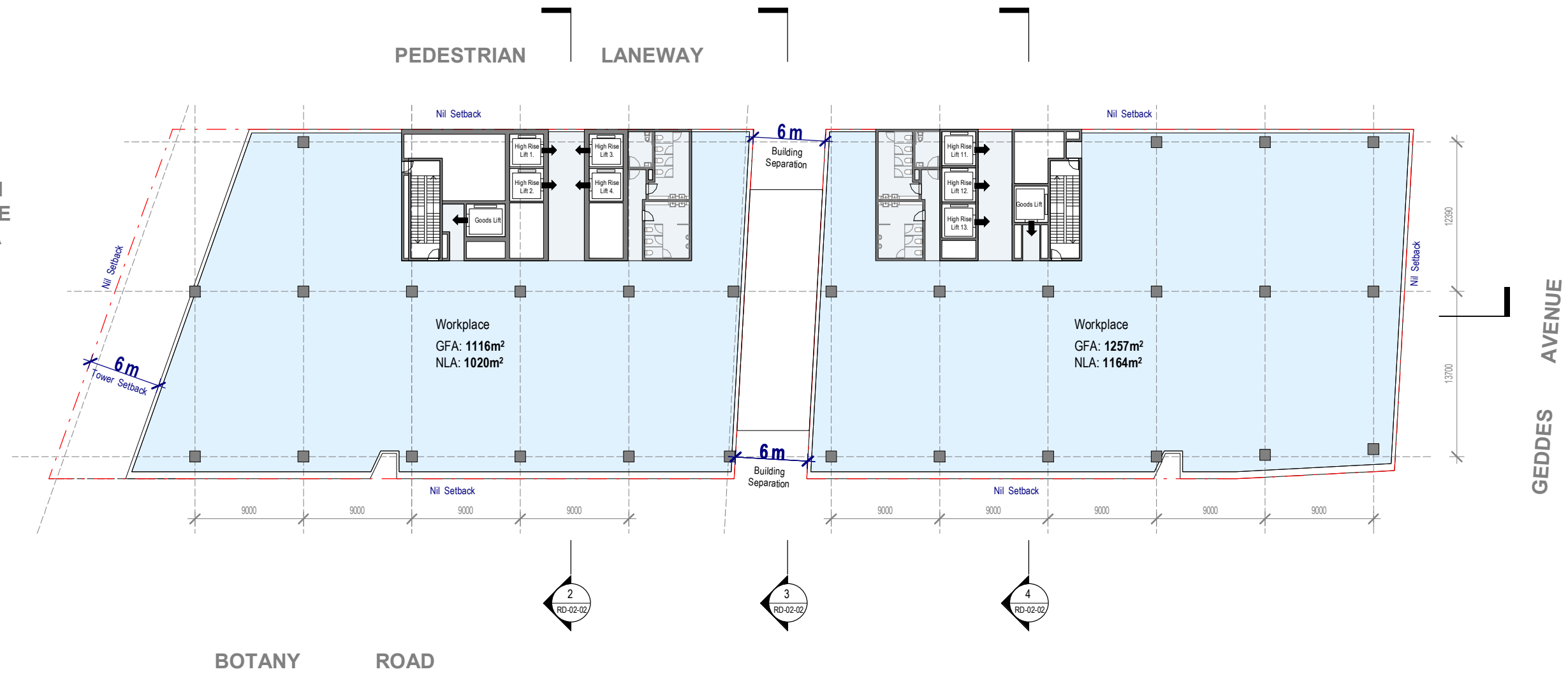

BOTANY ROAD

GEDDES AVENUE

Green Square Site 8A & 8B

Drawing: **Levels 10 - 16 (Typical High Rise Levels)**
 Drawing no: RD-01-08
 Issue:
 Scale @ A3: 1 : 400
 Date: 15/09/21

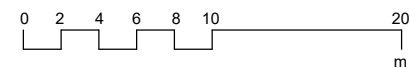
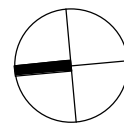

Architectus Sydney
 Level 18 MLC Centre
 19 Martin Place
 Sydney NSW 2000
 sydney@architectus.com.au

architectus™

308

GREEN SQUARE PLAZA

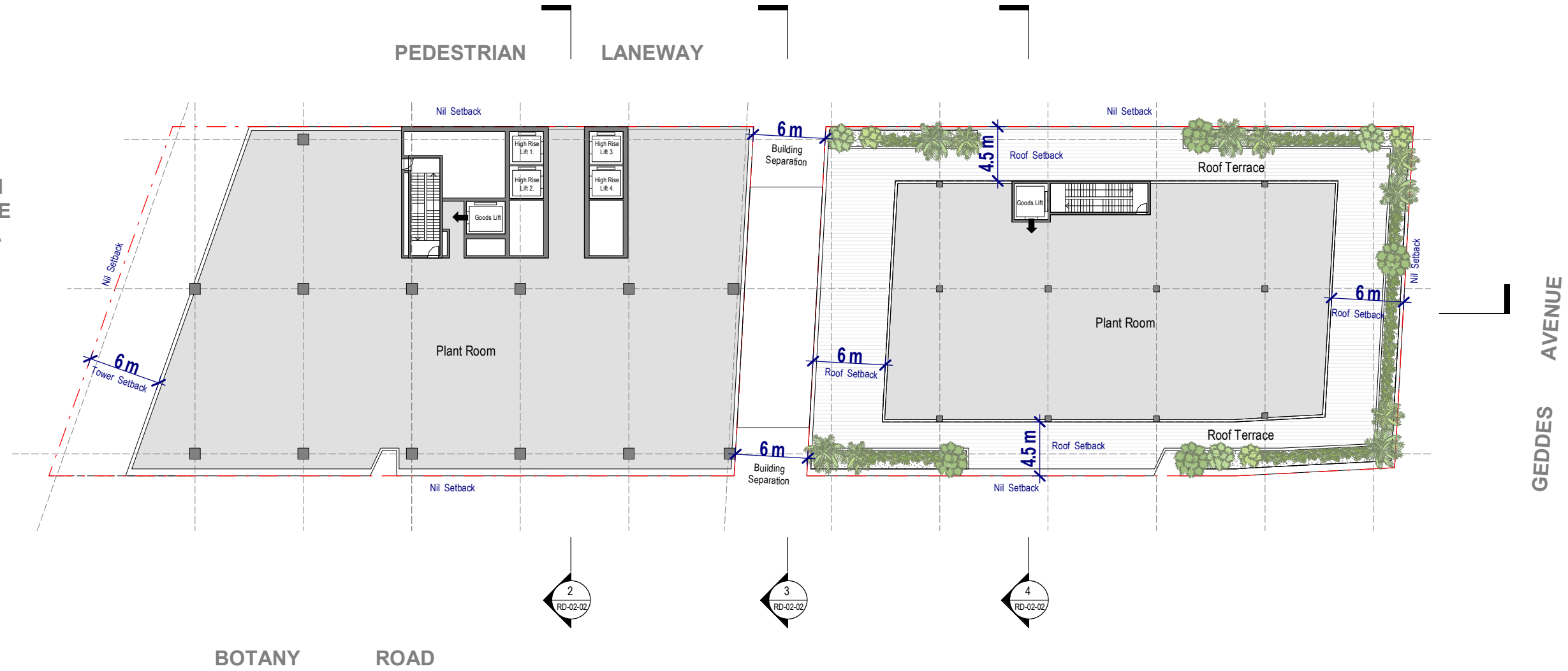

BOTANY ROAD

GEDDES AVENUE

Green Square Site 8A & 8B

Drawing: **Level 17 (Plant Level)**
 Drawing no: RD-01-09
 Issue:
 Scale @ A3: 1 : 400
 Date: 15/09/21

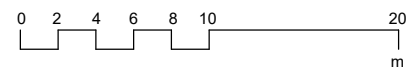
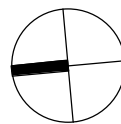

Architectus Sydney
 Level 18 MLC Centre
 19 Martin Place
 Sydney NSW 2000
 sydney@architectus.com.au

architectus™

303

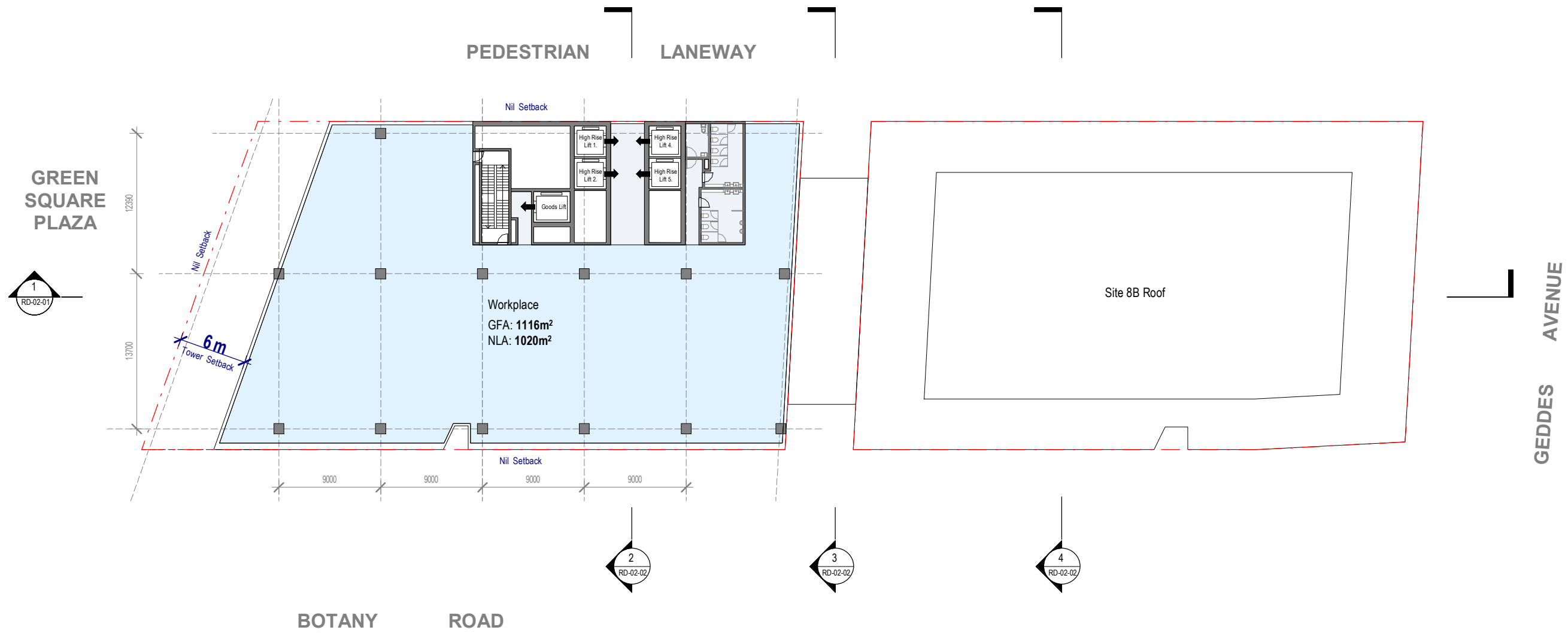

Green Square Site 8A & 8B

Drawing: **Levels 18 - 22 (Typical High Rise Levels)**
 Drawing no: RD-01-10
 Issue:
 Scale @ A3: 1 : 400
 Date: 15/09/21

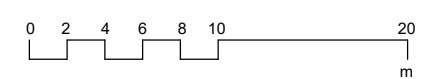
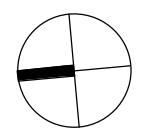

Architectus Sydney
 Level 18 MLC Centre
 19 Martin Place
 Sydney NSW 2000
 sydney@architectus.com.au



310

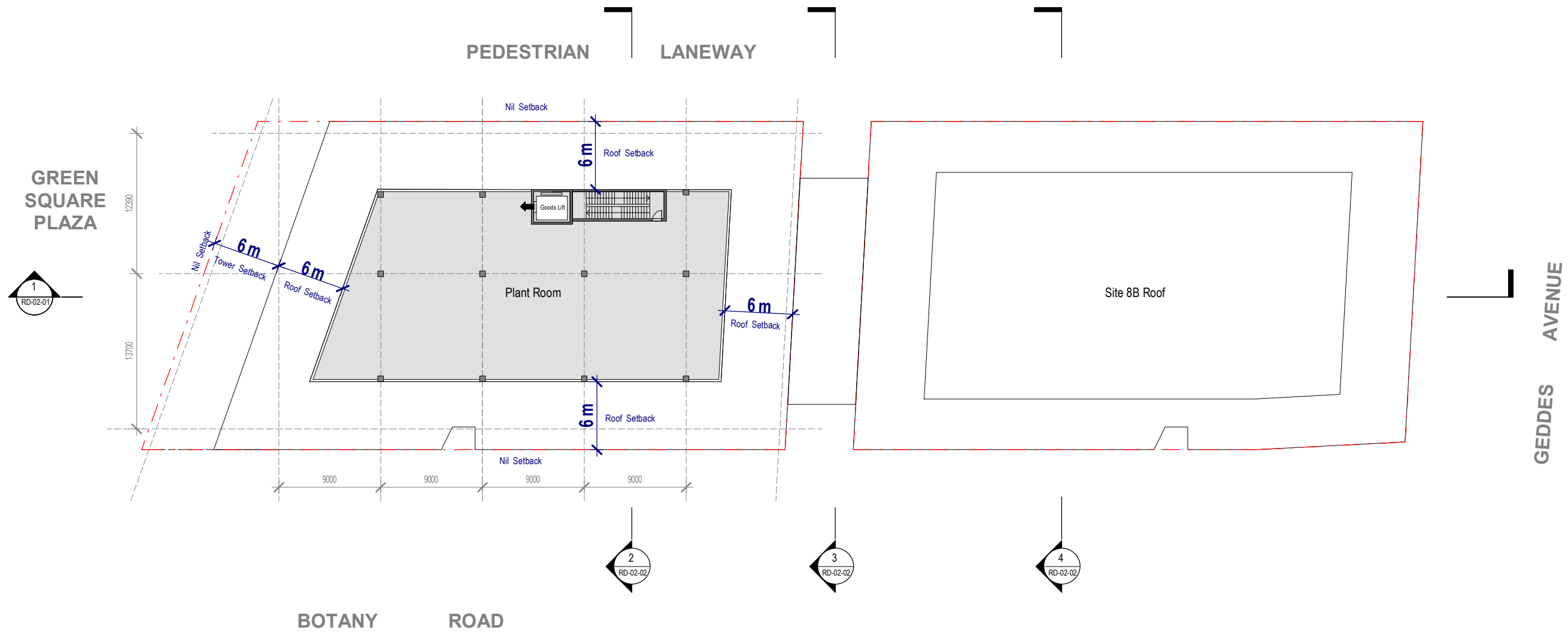

Green Square Site 8A & 8B

Drawing: **Level 23 (Roof Plant)**
 Drawing no: RD-01-11
 Issue:
 Scale @ A3: 1 : 400
 Date: 15/09/21

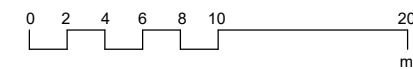
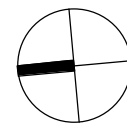

Architectus Sydney
 Level 18 MLC Centre
 19 Martin Place
 Sydney NSW 2000
 sydney@architectus.com.au



PAN OPS RL 115
LEP Height RL 115
DCP Height 97.5M

Site 8A Height Limit
RL 115.0

Site 8A Height Limit
RL 115.0

LEP Height RL 90
DCP Height 72.5M

Site 8B Height Limit
RL 90.0

Site 8B Height Limit
RL 90.0

LEP Height RL 52
DCP Height 33M

10 Storeys
RL 55.7
Podium Height Limit
RL 52.0

10 Storeys
RL 55.7

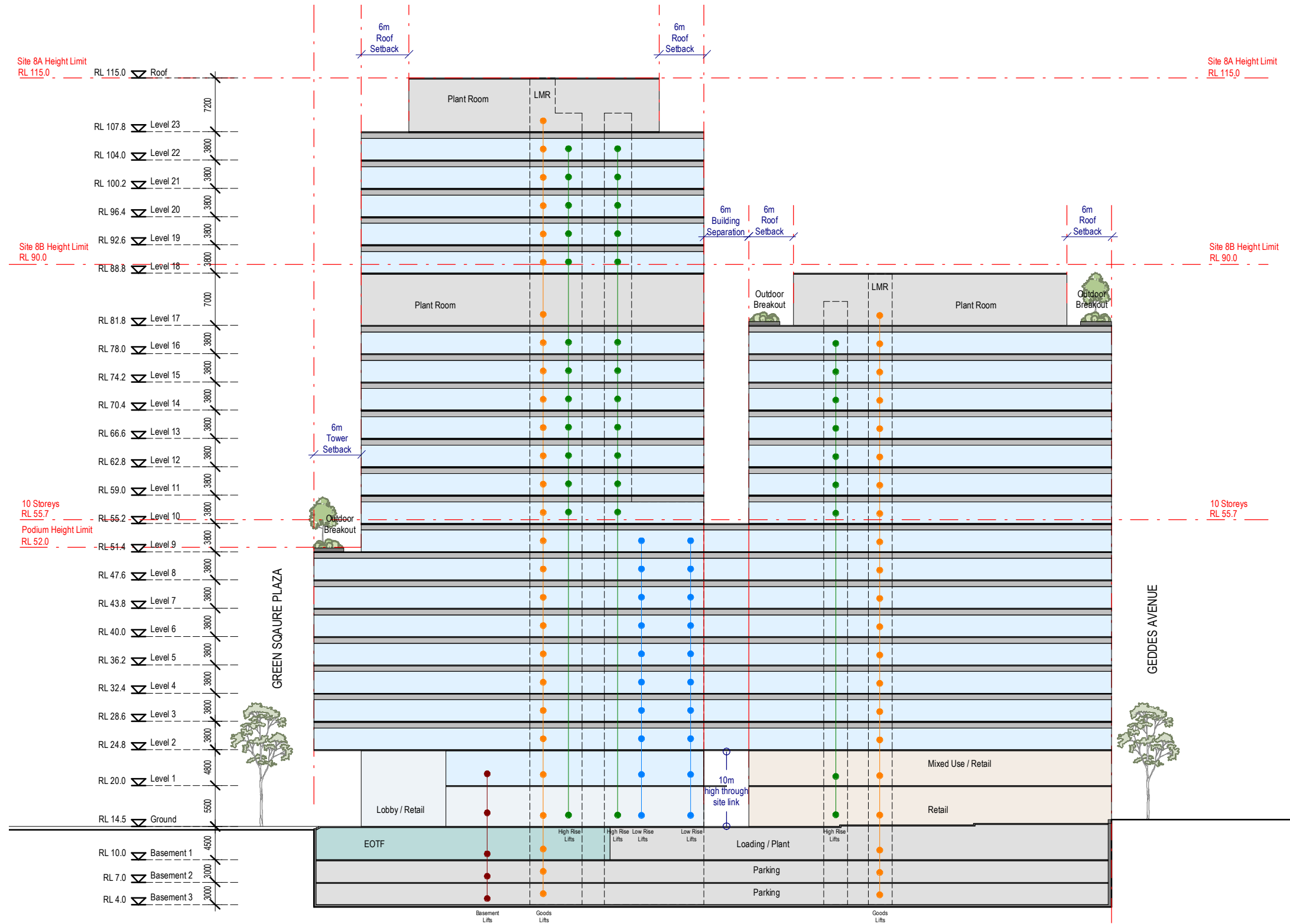

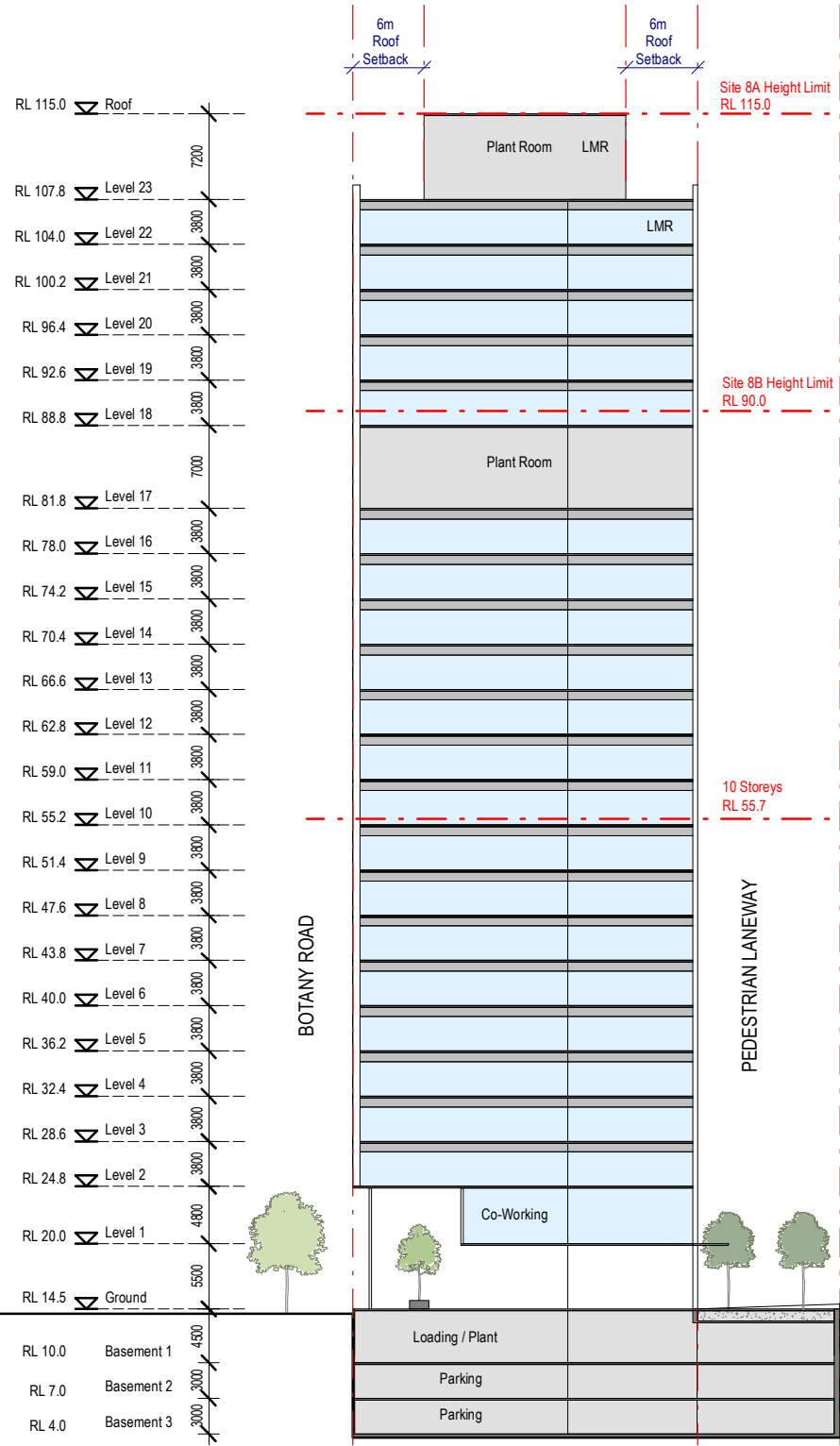

2 Complying DCP - Section 2
SCALE: 1 : 600

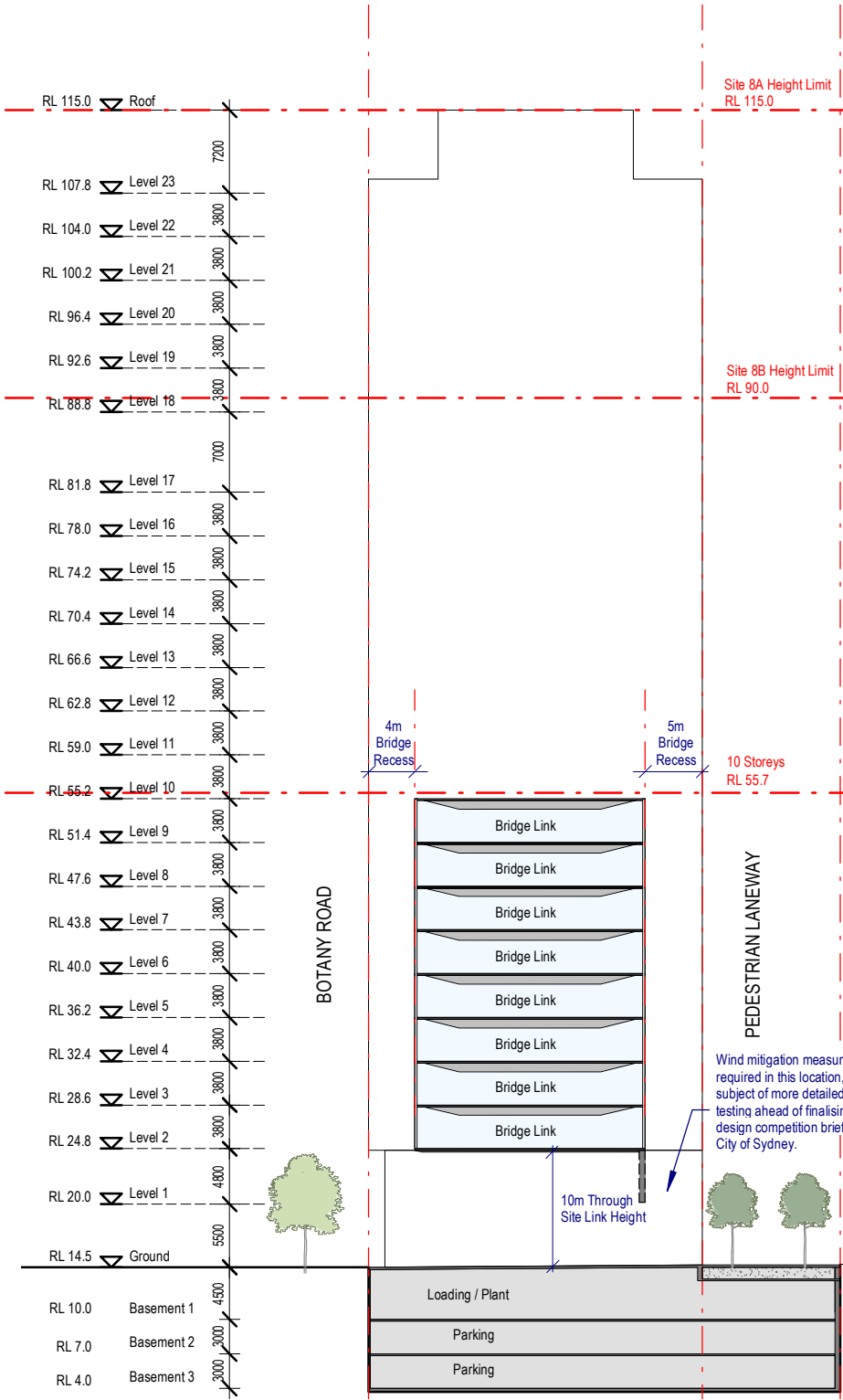

3 Complying DCP - Section 3
SCALE: 1 : 600

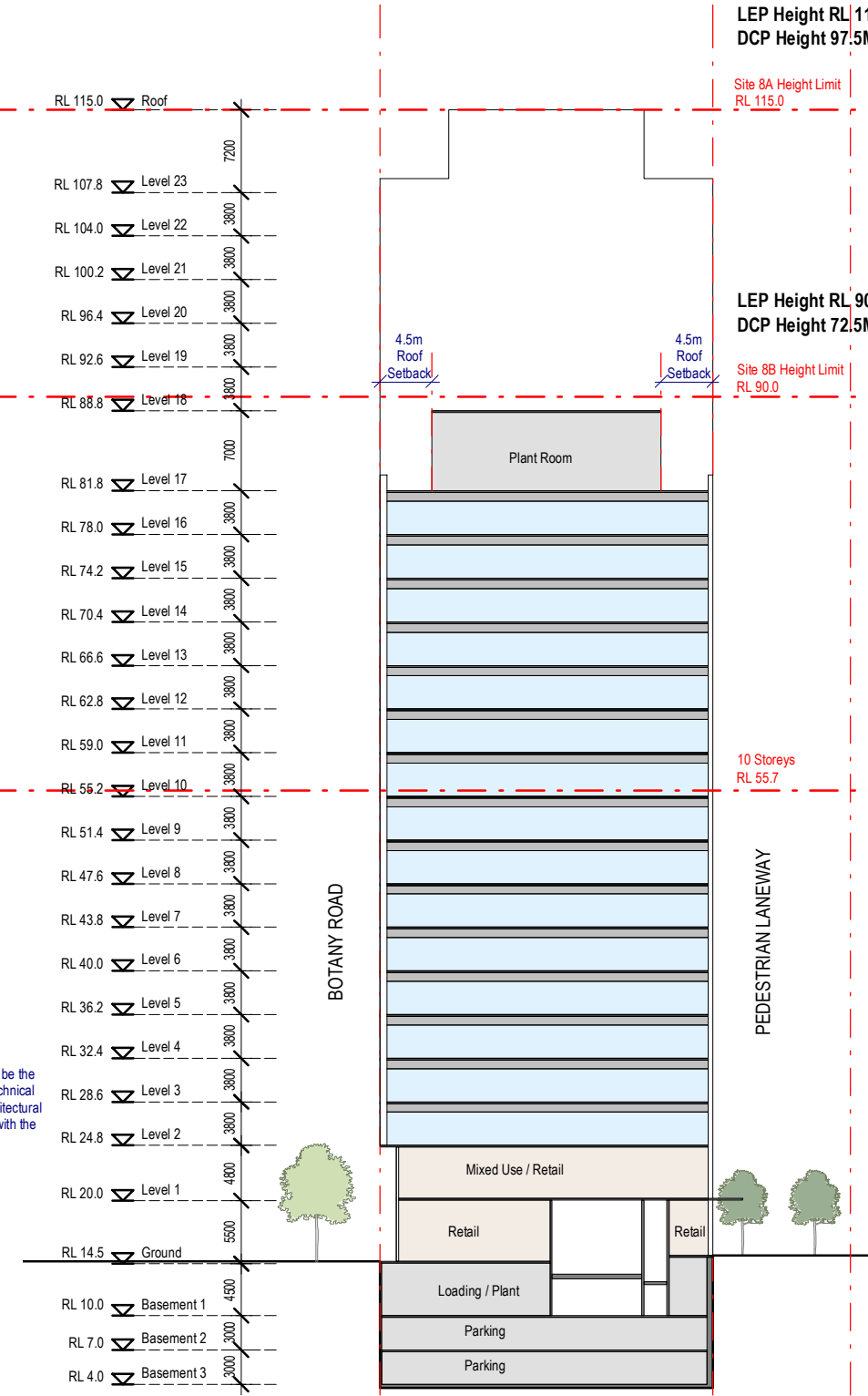

4 Complying DCP - Section 4
SCALE: 1 : 600

PAN OPS RL 115
LEP Height RL 115
DCP Height 97.5M

LEP Height RL 90
DCP Height 72.5M

Site 8B Height Limit
RL 90.0

10 Storeys
RL 55.7

PEDESTRIAN LANEWAY

